

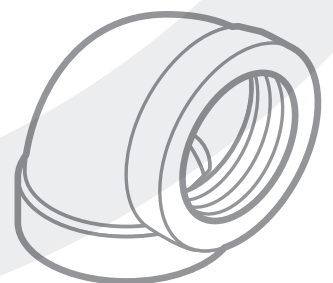

WARD INTERNATIONAL

**INTERNATIONAL MALLEABLE IRON
PIPE FITTINGS & UNIONS** | *PRICE SHEET*

PRICE SCHEDULE #100522_rev1
EFFECTIVE: MAY 31, 2022



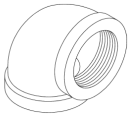

**90° ELBOWS
CLASS 150**

SIZE (INCHES)	B	G	INNER QTY	MASTER CARTON QTY	PART # BLACK	WEIGHT PER 100	LIST BLACK	PART # GALV.	WEIGHT PER 100	LIST GALV.
1/8			50	600	AL9004014	7	26.01	AL9003014	7	33.99
1/4			35	420	AL9004015	11	26.30	AL9003015	12	33.99
3/8			90	360	AL9004016	16	26.30	AL9003016	16	33.99
1/2	Δ	Δ	30	120	AL9004017	26	18.59	AL9003017	27	22.46
3/4	Δ	Δ	35	70	AL9004018	41	22.46	AL9003018	42	26.98
1	Δ	Δ	25	50	AL9004019	63	39.45	AL9003019	64	50.66
1-1/4	Δ	Δ	15	30	AL9004020	99	63.99	AL9003020	99	78.04
1-1/2	Δ	Δ	1	25	AL9004021	126	84.25	AL9003021	129	102.86
2	Δ	Δ	5	15	AL9004022	197	144.54	AL9003022	202	171.34
2-1/2			1	8	AL9004023	327	313.66	AL9003023	338	427.16
3			1	6	AL9004024	497	467.84	AL9003024	510	717.96
4			1	3	AL9004025	930	994.88	AL9003025	961	1242.75
6			1	1	AL9004027	1955	3721.37	AL9003027	1963	5266.66

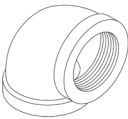

**REDUCING
90° ELBOWS
CLASS 150**

SIZE (INCHES)	B	G	INNER QTY	MASTER CARTON QTY	PART # BLACK	WEIGHT PER 100	PRICE (US\$) BLACK	PART # GALV.	WEIGHT PER 100	PRICE (US\$) GALV.
1/4 x 1/8		Δ	40	480	ARL04197	9	48.45	ARL03197	9	57.32
3/8 x 1/8			105	420	ARL04198	13	56.13	ARL03198	13	72.35
3/8 x 1/4			90	360	ARL04199	14	35.76	ARL03199	14	51.12
1/2 x 1/4			60	240	ARL04201	17	34.75	ARL03201	19	42.03
1/2 x 3/8			60	240	ARL04202	21	33.95	ARL03202	21	39.37
3/4 x 3/8			40	160	ARL04205	29	46.51	ARL03205	30	60.58
3/4 x 1/4	Δ		40	160	ARL04204	24	39.14			
3/4 x 1/2	Δ	Δ	30	90	ARL04206	33	35.21	ARL03206	35	45.77
1 x 3/8			25	100	ARL04209	39	73.41	ARL03209	39	95.00
1 x 1/2	Δ	Δ	35	70	ARL04210	44	47.79	ARL03210	46	61.96
1 x 3/4	Δ	Δ	30	60	ARL04211	54	44.99	ARL03211	56	58.43
1-1/4 x 1/2	Δ	Δ	25	50	ARL04215	62	97.15	ARL03215	64	120.01
1-1/4 x 3/4	Δ		10	40	ARL04216	67	83.12	ARL03216	69	117.62
1-1/4 x 1	Δ	Δ	1	35	ARL04217	82	73.28	ARL03217	84	97.93
1-1/2 x 1/2			15	60	ARL04221	76	122.78	ARL03221	79	153.79
1-1/2 x 3/4	Δ	Δ	1	35	ARL04222	88	120.11	ARL03222	91	150.61
1-1/2 x 1	Δ	Δ	10	30	ARL04223	92	120.11	ARL03223	95	150.61
1-1/2 x 1-1/4	Δ	Δ	1	25	ARL04224	119	120.11	ARL03224	121	150.61
2 x 1/2			10	40	ARL04228	119	176.66	ARL03228	107	213.41
2 x 3/4	Δ		1	25	ARL04229	125	176.66	ARL03229	130	213.41
2 x 1	Δ	Δ	12	24	ARL04230	143	173.20	ARL03230	149	209.22
2 x 1-1/4	Δ		10	20	ARL04231	152	173.20	ARL03231	160	209.22
2 x 1-1/2	Δ	Δ	9	18	ARL04232	163	152.24	ARL03232	169	182.76
2-1/2 x 1-1/2			6	12	ARL04240	220	424.76	ARL03240	245	669.09
2-1/2 x 2			6	12	ARL04241	265	417.42	ARL03241	278	595.73
3 x 2			4	8				ARL03247	386	940.75

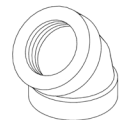

**45° ELBOWS
CLASS 150**

SIZE (INCHES)	B	G	INNER QTY	MASTER CARTON QTY	PART # BLACK	WEIGHT PER 100	PRICE (US\$) BLACK	PART # GALV.	WEIGHT PER 100	PRICE (US\$) GALV.
1/8			50	600	AL4504028	5	37.64	AL4503028	7	51.21
1/4			30	360	AL4504029	10	38.43	AL4503029	9	45.59
3/8			75	300	AL4504030	15	34.96	AL4503030	16	45.50
1/2	Δ	Δ	35	140	AL4504031	23	30.36	AL4503031	23	34.96
3/4	Δ	Δ	30	90	AL4504032	36	37.04	AL4503032	37	48.92
1	Δ	Δ	1	55	AL4504033	55	47.22	AL4503033	57	56.10
1-1/4	Δ	Δ	1	35	AL4504034	76	82.59	AL4503034	80	102.39
1-1/2	Δ	Δ	10	30	AL4504035	112	101.88	AL4503035	115	122.04
2	Δ	Δ	5	15	AL4504036	177	153.40	AL4503036	182	182.15
2-1/2			12	12	AL4504037	279	435.83	AL4503037	284	616.98
3			10	10	AL4504038	428	562.07	AL4503038	448	896.96
4			4	4	AL4504039	756	1092.03	AL4503039	772	1503.26
6			1	1	AL4504041	1492	3721.37	AL4503041	1512	5266.66

Δ sold in inner quantity only

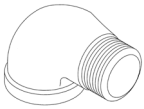

90° STREET ELLS CLASS 150

SIZE (INCHES)	B	G	INNER QTY	MASTER CARTON QTY	PART # BLACK	WEIGHT PER 100	PRICE (US\$) BLACK	PART # GALV.	WEIGHT PER 100	PRICE (US\$) GALV.
1/8			60	720	ASL9004042	6	37.58	ASL9003042	6	48.28
1/4			25	300	ASL9004043	10	37.58	ASL9003043	10	46.71
3/8			50	200	ASL9004044	16	37.58	ASL9003044	17	46.71
1/2	Δ	Δ	65	130	ASL9004045	24	38.49	ASL9003045	24	48.20
3/4	Δ	Δ	30	90	ASL9004046	38	37.58	ASL9003046	41	46.71
1	Δ	Δ	25	50	ASL9004047	59	54.01	ASL9003047	62	63.62
1-1/4	Δ	Δ	1	35	ASL9004048	93	82.59	ASL9003048	97	106.91
1-1/2	Δ	Δ	1	25	ASL9004049	126	110.09	ASL9003049	130	131.65
2	Δ	Δ	5	15	ASL9004050	222	178.57	ASL9003050	312	228.33
2-1/2			5	10	ASL9004051	362	440.76	ASL9003051	386	619.09
3			8	8	ASL9004052	533	677.05	ASL9003052	533	934.52
4			4	4	ASL9004053	935	1095.47	ASL9003053	954	1542.59

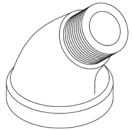

45° STREET ELLS CLASS 150

SIZE (INCHES)	B	G	INNER QTY	MASTER CARTON QTY	PART # BLACK	WEIGHT PER 100	PRICE (US\$) BLACK	PART # GALV.	WEIGHT PER 100	PRICE (US\$) GALV.
1/8			70	840	ASL4504056	5	58.40			
1/4			40	480	ASL4504057	9	43.40	ASL4503057	7	57.30
3/8			100	400	ASL4504058	13	49.34			
1/2	Δ	Δ	85	170	ASL4504059	22	39.60	ASL4503059	21	50.51
3/4	Δ	Δ	25	100	ASL4504060	32	60.93	ASL4503060	33	81.70
1	Δ	Δ	20	60	ASL4504061	56	70.67	ASL4503061	57	101.00
1-1/4	Δ		10	40	ASL4504062	78	122.32	ASL4503062	79	151.35
1-1/2	Δ		10	30	ASL4504063	113	151.87	ASL4503063	113	183.30
2	Δ		5	15	ASL4504064	175	256.10	ASL4503064	178	315.02



TEES CLASS 150

SIZE (INCHES)	B	G	INNER QTY	MASTER CARTON QTY	PART # BLACK	WEIGHT PER 100	PRICE (US\$) BLACK	PART # GALV.	WEIGHT PER 100	PRICE (US\$) GALV.
1/8			120	480	AT04084	10	39.68	AT03084	9	51.12
1/4			50	200	AT04085	15	37.57	AT03085	16	44.33
3/8			45	180	AT04086	24	37.57	AT03086	26	44.33
1/2	Δ	Δ	30	90	AT04087	37	24.25	AT03087	38	27.28
3/4	Δ	Δ	25	50	AT04088	22	34.35	AT03088	57	45.80
1	Δ	Δ	1	35	AT04089	88	60.57	AT03089	91	74.99
1-1/4	Δ	Δ	1	25	AT04090	133	98.37	AT03090	137	118.46
1-1/2	Δ	Δ	5	15	AT04091	160	122.32	AT03091	163	147.89
2	Δ	Δ	6	12	AT04092	267	207.95	AT03092	274	246.76
2-1/2	Δ	Δ	3	6	AT04093	488	427.72	AT03093	489	662.80
3			1	5	AT04094	650	642.03	AT03094	675	777.15
4			1	2	AT04095	1167	1507.41	AT03095	1193	1837.53
6			1	1	AT04097	2604	4306.93	AT03097	2605	5267.00



CROSSES CLASS 150

SIZE (INCHES)	B	G	INNER QTY	MASTER CARTON QTY	PART # BLACK	WEIGHT PER 100	PRICE (US\$) BLACK	PART # GALV.	WEIGHT PER 100	PRICE (US\$) GALV.
1/4			40	160	ACRO4113	19	76.02	ACRO3113	21	113.12
3/8			50	150	ACRO4114	29	77.59	ACRO3114	27	113.12
1/2	Δ	Δ	35	70	ACRO4115	44	88.25	ACRO3115	44	113.40
3/4	Δ	Δ	10	40	ACRO4116	66	107.68	ACRO3116	69	138.16
1	Δ	Δ	15	30	ACRO4117	102	132.41	ACRO3117	106	190.78
1-1/4	Δ		10	20	ACRO4118	159	215.13	ACRO3118	164	276.05
1-1/2	Δ	Δ	5	15	ACRO4119	207	266.41	ACRO3119	191	335.10
2			5	10	ACRO4120	313	441.11	ACRO3120	315	639.05

Δ sold in inner quantity only



**REDUCING
TEES
CLASS 150**

SIZE (INCHES)	B	G	INNER QTY	MASTER CARTON QTY	PART # BLACK	WEIGHT PER 100	PRICE (US\$) BLACK	PART # GALV.	WEIGHT PER 100	PRICE (US\$) GALV.
1/2 x 1/2 x 1/4			40	160	ART04284	28	41.27	ART03284	30	52.67
1/2 x 1/2 x 3/8			40	160	ART04285	30	51.60	ART03285	32	66.95
1/2 x 1/2 x 3/4	Δ	Δ	35	70	ART04363	43	60.57	ART03363	45	72.35
1/2 x 1/2 x 1	Δ		15	60	ART04364	53	87.72	ART03364	56	108.07
3/4 x 1/2 x 1/2			25	100	ART04365	40	54.92	ART03365	42	72.35
3/4 x 1/2 x 3/4			20	80	ART04366	49	61.02	ART03366	52	72.90
3/4 X 3/4 X 1/4			25	100	ART04287	38	58.16	ART03287	39	65.75
3/4 X 3/4 X 3/8	Δ		25	100	ART04288	40	61.78	ART03288	40	65.75
3/4 X 3/4 X 1/2	Δ	Δ	15	60	ART04289	49	53.01	ART03289	51	63.28
3/4 x 3/4 x 1	Δ		30	60	ART04368	65	76.82	ART03368	67	106.91
3/4 x 3/4 x 1-1/4			10	30	ART04369	78	142.43	ART03369	77	182.64
1 x 1/2 x 1/2			20	80	ART04371	50	76.82	ART03371	52	106.91
1 x 1/2 x 3/4			20	80	ART04372	66	89.55	ART03372	66	109.10
1 x 1/2 x 1			15	60	ART04373	73	77.32	ART03373	74	107.64
1 x 3/4 x 1/2			20	80	ART04374	63	76.02	ART03374	64	108.03
1 X 3/4 X 3/4			15	60	ART04375	60	71.57			
1 x 3/4 x 1			30	60	ART04376	83	77.32			
1 x 1 x 3/8			15	60	ART04292	61	84.30	ART03292	63	109.10
1 x 1 x 1/2	Δ	Δ	15	45	ART04293	67	67.41	ART03293	69	88.79
1 x 1 x 3/4	Δ	Δ	10	40	ART04294	77	67.41	ART03294	79	88.79
1 x 1 x 1-1/4			10	40	ART04377	91	142.49	ART03377	103	170.04
1 x 1 x 1-1/2			5	20	ART04378	115	212.90	ART03378	116	289.28
1 x 1 x 2			10	20	ART04379	142	260.93	ART03379	143	296.95
1-1/4 x 1/2 x 1			20	40	ART04382	88	136.35	ART03382	93	167.02
1-1/4 x 3/4 x 3/4			10	40	ART04385	90	142.72	ART03385	93	182.91
1-1/4 x 3/4 x 1			10	40	ART04386	97	130.45	ART03386	101	175.23
1-1/4 x 3/4 x 1-1/4			20	40	ART04387	110	128.01	ART03387	115	159.11
1-1/4 x 1 x 1/2			20	40	ART04388	79	130.13	ART03388	80	166.59
1-1/4 x 1 x 3/4			20	40	ART04389	85	122.90	ART03389	86	167.02
1-1/4 x 1 x 1			20	40	ART04390	104	122.90	ART03390	108	167.02
1-1/4 x 1 x 1-1/4	Δ		15	30	ART04391	120	119.91			
1-1/4 x 1-1/4 x 1/2	Δ	Δ	1	35	ART04298	93	122.32	ART03298	97	145.23
1-1/4 x 1-1/4 x 3/4	Δ	Δ	15	30	ART04299	104	107.25	ART03299	106	137.30
1-1/4 x 1-1/4 x 1	Δ	Δ	1	25	ART04300	118	107.25	ART03300	123	137.30
1-1/4 x 1-1/4 x 1-1/2			10	20	ART04393	138	167.02	ART03393	145	209.80
1-1/4 x 2			9	18	ART04394	172	260.93	ART03394	182	296.95
1-1/2 x 3/4 x 3/4			15	30	ART04399	83	266.33	ART03399	87	304.85
1-1/2 x 3/4 x 1-1/2			12	24	ART04401	129	168.16			
1-1/2 x 1 x 3/4			15	30	ART04403	113	168.16			
1-1/2 x 1 x 1			15	30	ART04404	111	167.02	ART03404	116	210.40
1-1/2 x 1 x 1-1/4			12	24	ART04405	123	168.16	ART03405	127	210.40
1-1/2 x 1 x 1-1/2			12	24	ART04406	140	168.16			
1-1/2 x 1-1/4 x 1/2			12	24	ART04407	100	168.16			
1-1/2 x 1-1/4 x 3/4			12	24	ART04408	112	167.02	ART03408	104	210.40
1-1/2 x 1-1/4 x 1			12	24	ART04409	129	143.24	ART03409	137	206.37
1-1/2 x 1-1/4 x 1-1/4			12	24	ART04410	161	225.78	ART03410	139	294.01
1-1/2 x 1-1/4 x 1-1/2			12	24	ART04411	155	227.40			
1-1/2 x 1-1/4 x 2			8	16	ART04412	187	260.93	ART03412	187	297.49
1-1/2 x 1-1/2 x 1/2	Δ	Δ	1	25	ART04304	107	143.26	ART03304	109	179.65
1-1/2 x 1-1/2 x 3/4	Δ	Δ	1	25	ART04305	117	135.57	ART03305	122	169.96
1-1/2 x 1-1/2 x 1	Δ	Δ	10	20	ART04306	136	135.57	ART03306	137	169.96
1-1/2 x 1-1/2 x 1-1/4	Δ		10	20	ART04307	152	167.02	ART03307	158	210.40
1-1/2 x 1-1/2 x 2			7	14	ART04413	194	260.93	ART03413	198	297.49
2 x 3/4 x 2			8	16	ART04416	219	255.75	ART03416	228	291.83
2 x 1 x 2	Δ		8	16	ART04419	212	219.63			
2 x 1-1/4 x 1-1/4			8	16	ART04421	197	260.93	ART03421	154	297.47
2 x 1-1/4 x 1-1/2			8	16	ART04422	171	287.89			
2 x 1-1/4 x 2			8	16	ART04423	220	296.72			
2 x 1-1/2 x 1			10	20	ART04425	177	255.75	ART03425	181	292.71
2 x 1-1/2 x 1-1/4			8	16	ART04426	168	260.93	ART03426	178	297.49
2 x 1-1/2 x 1-1/2			8	16	ART04427	180	255.75	ART03427	182	288.38
2 x 1-1/2 x 2			8	16	ART04428	227	262.57			
2 x 2 x 1/2	Δ	Δ	5	15	ART04311	149	212.25	ART03311	155	275.01
2 x 2 x 3/4	Δ	Δ	5	15	ART04312	176	212.29	ART03312	184	247.93
2 X 2 X 1	Δ	Δ	5	15	ART04313	178	212.29	ART03313	187	247.93
2 x 2 x 1-1/4	Δ	Δ	6	12	ART04314	200	224.37	ART03314	202	288.38

Δ sold in inner quantity only



REDUCING TEES CLASS 150, cont.

SIZE (INCHES)	B	G	INNER QTY	MASTER CARTON QTY	PART # BLACK	WEIGHT PER 100	PRICE (US\$) BLACK	PART # GALV.	WEIGHT PER 100	PRICE (US\$) GALV.
2 x 2 x 1-1/2	Δ	Δ	6	12	ART04315	235	224.37	ART03315	244	288.38
2 x 2 x 2-1/2			6	12	ART04429	326	561.53	ART03429	327	870.59
2-1/2 x 2 x 2			5	10				ART03430	341	792.72
2-1/2 x 2-1/2 x 3/4			6	12	ART04320	280	556.17	ART03320	285	791.27
2-1/2 x 2-1/2 x 1			5	10	ART04321	304	556.17	ART03321	304	791.27
2-1/2 x 2-1/2 x 1-1/4			5	10	ART04322	326	556.17	ART03322	339	791.27
2-1/2 x 2-1/2 x 1-1/2			5	10	ART04323	332	556.17	ART03323	348	791.27
2-1/2 x 2-1/2 x 2			4	8	ART04324	376	556.17	ART03324	401	791.27
3 x 3 x 3/4			3	6	ART04326	293	757.32	ART03326	321	1121.89
3 x 3 x 1			3	6	ART04327	436	742.91	ART03327	436	1073.70
3 x 3 x 1-1/4			3	6	ART04328	374	757.32	ART03328	381	1094.33
3 x 3 x 1-1/2			3	6	ART04329	479	747.75			
3 x 3 x 2			3	6	ART04330	526	742.91	ART03330	546	1073.70
3 x 3 x 2-1/2			3	6	ART04331	600	855.20	ART03331	625	1205.35
4 x 4 x 2-1/2			3	3	ART04342	924	1697.91	ART03342	959	2366.50
4 x 4 x 3			1	2	ART04343	924	1504.38	ART03343	1018	2148.03



COUPLINGS CLASS 150

SIZE (INCHES)	B	G	INNER QTY	MASTER CARTON QTY	PART # BLACK	WEIGHT PER 100	PRICE (US\$) BLACK	PART # GALV.	WEIGHT PER 100	PRICE (US\$) GALV.
1/8			70	840	AS04000	6	36.54	AS03000	6	42.39
1/4			25	300	AS04001	9	30.95	AS03001	9	39.45
3/8			40	480	AS04002	13	30.95	AS03002	13	39.45
1/2	Δ	Δ	50	150	AS04003	20	25.18	AS03003	21	31.67
3/4	Δ	Δ	25	100	AS04004	29	29.72	AS03004	30	36.61
1	Δ	Δ	35	70	AS04005	46	44.98	AS03005	47	60.36
1-1/4	Δ	Δ	15	45	AS04006	70	57.58	AS03006	73	83.07
1-1/2	Δ	Δ	1	35	AS04007	93	76.98	AS03007	95	94.58
2	Δ	Δ	10	20	AS04008	145	112.13	AS03008	153	138.07
2-1/2			8	16	AS04009	228	305.32	AS03009	231	421.78
3			12	12	AS04010	361	412.57	AS03010	369	563.63
4			3	6	AS04011	575	822.82	AS03011	581	1197.20



CAPS CLASS 150

SIZE (INCHES)	B	G	INNER QTY	MASTER CARTON QTY	PART # BLACK	WEIGHT PER 100	PRICE (US\$) BLACK	PART # GALV.	WEIGHT PER 100	PRICE (US\$) GALV.
1/8			120	1440	ACA04126	4	24.37	ACA03126	4	31.48
1/4			80	960	ACA04127	5	24.37	ACA03127	6	31.48
3/8			60	720	ACA04128	8	24.37	ACA03128	8	30.53
1/2	Δ	Δ	50	200	ACA04129	13	18.65	ACA03129	13	23.41
3/4	Δ	Δ	65	130	ACA04130	21	25.18	ACA03130	21	33.89
1	Δ	Δ	35	70	ACA04131	31	30.36	ACA03131	33	37.13
1-1/4	Δ	Δ	25	50	ACA04132	44	39.68	ACA03132	44	54.01
1-1/2	Δ	Δ	10	40	ACA04133	56	53.99	ACA03133	59	68.98
2	Δ	Δ	1	35	ACA04134	93	70.64	ACA03134	93	87.21
2-1/2			20	40	ACA04135	160	175.47	ACA03135	169	277.47
3			1	24	ACA04136	236	260.93	ACA03136	236	336.15
4			6	12	ACA04137	390	407.13	ACA03137	397	667.72

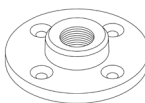

FLOOR FLANGES CLASS 150

SIZE (INCHES)	B	G	INNER QTY	MASTER CARTON QTY	PART # BLACK	WEIGHT PER 100	PRICE (US\$) BLACK	PART # GALV.	WEIGHT PER 100	PRICE (US\$) GALV.
1/2	Δ		25	50	AFF04143	66	67.52	AFF03143	66	143.18
3/4	Δ		15	45	AFF04144	72	72.74	AFF03144	76	159.87
1	Δ		15	40	AFF04145	98	94.36	AFF03145	104	175.80
1-1/4	Δ		10	30	AFF04146	102	101.00	AFF03146	103	200.17
1-1/2	Δ		8	24	AFF04147	136	110.15	AFF03147	142	249.82
2	Δ		7	14	AFF04148	219	143.59	AFF03148	229	329.10

Δ sold in inner quantity only

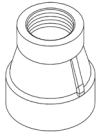

**REDUCING
COUPLINGS
CLASS 150**

SIZE (INCHES)	B	G	INNER QTY	MASTER CARTON QTY	PART # BLACK	WEIGHT PER 100	PRICE (US\$) BLACK	PART # GALV.	WEIGHT PER 100	PRICE (US\$) GALV.
1/4 x 1/8			50	600	ARS04463	7	30.11	ARS03463	8	37.13
3/8 x 1/8			35	420	ARS04464	10	30.11	ARS03464	10	37.57
3/8 x 1/4			30	360	ARS04465	11	30.11	ARS03465	11	37.13
1/2 x 1/8			75	300	ARS04466	16	29.89	ARS03466	16	41.77
1/2 x 1/4			75	300	ARS04467	16	30.11	ARS03467	17	33.89
1/2 x 3/8			60	240	ARS04468	16	25.93	ARS03468	17	31.67
3/4 x 1/8			70	210	ARS04469	20	34.96	ARS03469	21	42.76
3/4 x 1/4			45	180	ARS04470	23	33.99	ARS03470	24	41.92
3/4 x 3/8			45	180	ARS04471	24	33.99	ARS03471	22	41.92
3/4 x 1/2	Δ	Δ	40	120	ARS04472	26	29.72	ARS03472	28	37.05
1 x 1/4			45	135	ARS04474	32	52.67	ARS03474	33	74.33
1 x 3/8			30	120	ARS04475	34	53.48	ARS03475	36	75.98
1 x 1/2	Δ	Δ	20	80	ARS04476	40	46.01	ARS03476	40	61.78
1 x 3/4	Δ	Δ	20	80	ARS04477	41	46.01	ARS03477	41	57.32
1-1/4 x 1/2	Δ	Δ	1	55	ARS04481	52	66.35	ARS03481	54	97.27
1-1/4 x 3/4	Δ	Δ	1	55	ARS04482	58	57.58	ARS03482	60	78.57
1-1/4 x 1	Δ	Δ	15	45	ARS04483	66	57.58	ARS03483	67	78.57
1-1/2 x 1/2	Δ	Δ	15	45	ARS04487	66	84.30	ARS03487	71	114.45
1-1/2 x 3/4	Δ	Δ	10	40	ARS04488	71	95.03	ARS03488	74	101.21
1-1/2 x 1	Δ	Δ	20	40	ARS04489	99	84.30	ARS03489	86	101.21
1-1/2 x 1-1/4	Δ	Δ	1	35	ARS04490	89	72.74	ARS03490	92	95.72
2 x 1/2	Δ	Δ	7	28	ARS04494	115	137.40	ARS03494	117	165.12
2 x 3/4	Δ	Δ	7	28	ARS04495	119	120.89	ARS03495	119	165.12
2 x 1	Δ	Δ	1	25	ARS04496	125	114.45	ARS03496	129	138.07
2 x 1-1/4	Δ	Δ	1	25	ARS04497	131	120.89	ARS03497	135	145.83
2 x 1-1/2	Δ	Δ	8	24	ARS04498	138	105.74	ARS03498	139	138.07
2-1/2 x 1			10	20	ARS04504	211	307.39			
2-1/2 x 1-1/4			10	20	ARS04505	184	307.39	ARS03505	221	426.49
2-1/2 x 1-1/2			7	14	ARS04506	225	314.42	ARS03506	226	435.26
2-1/2 x 2			7	14	ARS04507	229	269.76	ARS03507	242	427.08
3 x 1			6	12	ARS04510	311	428.50	ARS03510	311	578.15
3 x 1-1/4			6	12	ARS04511	297	428.50	ARS03511	304	578.15
3 x 1-1/2			6	12	ARS04512	299	420.50	ARS03512	311	567.24
3 x 2			6	12	ARS04513	333	348.72	ARS03513	342	536.15
3 x 2-1/2			5	10	ARS04514	364	420.50	ARS03514	370	567.24
4 x 2			3	6	ARS04524	547	843.05	ARS03524	569	1227.70
4 x 3			3	6	ARS04526	571	843.05	ARS03526	595	1227.70

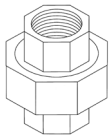

**UNIONS
BRASS TO
IRON
CLASS 150**

SIZE (INCHES)	B	G	INNER QTY	MASTER CARTON QTY	PART # BLACK	WEIGHT PER 100	PRICE (US\$) BLACK	PART # GALV.	WEIGHT PER 100	PRICE (US\$) GALV.
1/8	Δ	Δ	60	240	ACU04182	13	134.16	ACU03182	13	158.39
1/4	Δ	Δ	20	240	ACU04183	21	127.67	ACU03183	21	152.91
3/8	Δ	Δ	40	160	ACU04184	35	86.11	ACU03184	35	101.72
1/2	Δ	Δ	40	80	ACU04185	43	82.24	ACU03185	44	102.78
3/4	Δ	Δ	1	55	ACU04186	60	98.04	ACU03186	62	121.98
1	Δ	Δ	20	40	ACU04187	91	128.12	ACU03187	102	151.78
1-1/4	Δ	Δ	10	20	ACU04188	136	169.92	ACU03188	139	206.28
1-1/2	Δ	Δ	10	20	ACU04189	175	207.52	ACU03189	181	264.23
2	Δ	Δ	6	12	ACU04190	267	313.55	ACU03190	272	352.90
2-1/2	Δ	Δ	4	8	ACU04191	448	755.57	ACU03191	451	981.82
3	Δ	Δ	3	6	ACU04192	595	917.32	ACU03192	596	1395.11
4	Δ	Δ	2	4	ACU04193	1011	2268.29	ACU03193	1037	3030.08

Δ sold in inner quantity only

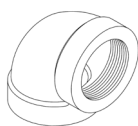

**EXTRA HEAVY
90° ELBOWS
CLASS 300**

SIZE (INCHES)	B	G	INNER QTY	MASTER CARTON QTY	PART # BLACK	WEIGHT PER 100	PRICE (US\$) BLACK	PART # GALV.	WEIGHT PER 100	PRICE (US\$) GALV.
1/4			85	170	AXHL9008015	21	102.36	AXHL9007015	20	173.09
3/8			55	110	AXHL9008016	30	90.91	AXHL9007016	30	176.63
1/2	Δ		35	70	AXHL9008017	47	117.78	AXHL9007017	48	210.30
3/4	Δ		15	45	AXHL9008018	75	133.22	AXHL9007018	77	236.08
1	Δ		15	30	AXHL9008019	115	170.12	AXHL9007019	120	302.64
1-1/4			9	18	AXHL9008020	186	248.13	AXHL9007020	189	475.40
1-1/2	Δ		5	15	AXHL9008021	243	292.51	AXHL9007021	243	515.39
2	Δ		3	9	AXHL9008022	397	420.87	AXHL9007022	402	866.05
2-1/2			1	5	AXHL9008023	622	1090.87	AXHL9007023	640	1856.74
3			1	3	AXHL9008024	958	1252.71	AXHL9007024	993	2273.36
4			1	1	AXHL9008025	1481	2861.97	AXHL9007025	1526	6606.84

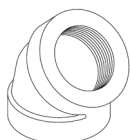

**EXTRA HEAVY
45° ELBOWS
CLASS 300**

SIZE (INCHES)	B	G	INNER QTY	MASTER CARTON QTY	PART # BLACK	WEIGHT PER 100	PRICE (US\$) BLACK	PART # GALV.	WEIGHT PER 100	PRICE (US\$) GALV.
1/4			90	180	AXHL4508029	19	152.24	AXHL4507029	18	204.86
3/8			65	130	AXHL4508030	29	152.24	AXHL4507030	28	234.48
1/2			40	80	AXHL4508031	43	169.46	AXHL4507031	44	312.18
3/4			25	50	AXHL4508032	68	188.40	AXHL4507032	70	361.02
1			15	30	AXHL4508033	106	208.47	AXHL4507033	107	394.53
1-1/4			10	20	AXHL4508034	167	334.11	AXHL4507034	173	612.40
1-1/2			5	15	AXHL4508035	217	435.53	AXHL4507035	223	792.26
2			5	10	AXHL4508036	362	657.97	AXHL4507036	367	1097.36
2-1/2			3	6	AXHL4508037	564	1429.55	AXHL4507037	570	2851.33
3			2	4	AXHL4508038	876	1879.80	AXHL4507038	876	3747.64
4			1	2	AXHL4508039	1252	4269.49	AXHL4507039	1172	5414.71



**EXTRA HEAVY
90° STREET
ELBOWS
CLASS 300**

SIZE (INCHES)	B	G	INNER QTY	MASTER CARTON QTY	PART # BLACK	WEIGHT PER 100	PRICE (US\$) BLACK	PART # GALV.	WEIGHT PER 100	PRICE (US\$) GALV.
1/4			180	360	AXHSL9008043	15	121.09	AXHSL9007043	18	182.15
3/8			70	140	AXHSL9008044	26	135.67	AXHSL9007044	26	182.15
1/2			40	80	AXHSL9008045	40	158.08	AXHSL9007045	41	356.91
3/4			25	50	AXHSL9008046	63	224.66	AXHSL9007046	66	378.98
1			1	35	AXHSL9008047	103	263.46	AXHSL9007047	103	495.73
1-1/4			10	20	AXHSL9008048	168	362.48	AXHSL9007048	171	651.70
1-1/2			8	16	AXHSL9008049	221	448.00	AXHSL9007049	231	832.29
2			3	9	AXHSL9008050	364	697.24	AXHSL9007050	373	1300.83



**EXTRA HEAVY
TEES
CLASS 300**

SIZE (INCHES)	B	G	INNER QTY	MASTER CARTON QTY	PART # BLACK	WEIGHT PER 100	PRICE (US\$) BLACK	PART # GALV.	WEIGHT PER 100	PRICE (US\$) GALV.
1/4			65	130	AXHT08085	29	128.91	AXHT07085	30	246.32
3/8			40	80	AXHT08086	43	136.45	AXHT07086	44	251.00
1/2			25	50	AXHT08087	68	173.78	AXHT07087	70	314.13
3/4			15	30	AXHT08088	108	187.68	AXHT07088	110	346.04
1			10	20	AXHT08089	157	225.54	AXHT07089	157	426.41
1-1/4			7	14	AXHT08090	250	323.20	AXHT07090	256	608.76
1-1/2			5	10	AXHT08091	334	377.02	AXHT07091	335	633.07
2			3	6	AXHT08092	522	556.37	AXHT07092	536	1012.11
2-1/2			2	4	AXHT08093	866	1315.01	AXHT07093	874	3111.01
3			1	2	AXHT08094	1287	1927.89	AXHT07094	1332	3626.82
4			1	1	AXHT08095	2063	5341.76	AXHT07095	2015	9056.57

Δ sold in inner quantity only

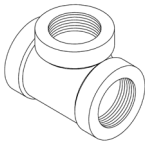

**EXTRA HEAVY
REDUCING
TEES
CLASS 300**

SIZE (INCHES)	B	G	INNER QTY	MASTER CARTON QTY	PART # BLACK	WEIGHT PER 100	PRICE (US\$) BLACK	PART # GALV.	WEIGHT PER 100	PRICE (US\$) GALV.
3/4 x 1/2			1	35	AXHRT08289	92	276.96	AXHRT07289	93	459.42
1 x 1/2			1	25	AXHRT08293	127	338.62	AXHRT07293	128	548.57
1 x 3/4			1	25	AXHRT08294	140	338.62	AXHRT07294	113	603.46
1-1/4 x 1/2			12	24	AXHRT08298	202	506.76	AXHRT07298	186	867.71
1-1/4 x 3/4			8	16	AXHRT08299	200	450.55	AXHRT07299	202	800.80
1-1/4 x 1			8	16	AXHRT08300	227	467.74	AXHRT07300	229	800.80
1-1/2 x 1/2			10	20	AXHRT08304	233	594.91	AXHRT07304	241	967.39
1-1/2 x 3/4			10	20	AXHRT08305	245	573.85	AXHRT07305	247	989.30
1-1/2 x 1			6	12	AXHRT08306	271	548.49	AXHRT07306	276	989.30
1-1/2 x 1-1/4			5	10	AXHRT08307	311	600.67	AXHRT07307	304	1271.96
2 x 3/4			6	12	AXHRT08312	361	890.11	AXHRT07312	364	1577.95
2 x 1			5	10	AXHRT08313	395	889.92	AXHRT07313	397	1333.49
2 x 1-1/4			4	8	AXHRT08314	432	884.13	AXHRT07314	453	1852.40
2 x 1-1/2			1	7	AXHRT08315	472	822.20	AXHRT07315	478	1456.07
2-1/2 x 2			2	4	AXHRT08324	776	2016.13	AXHRT07324	758	2579.41
3 x 2			1	3	AXHRT08330	967	3741.21	AXHRT07330	1038	6854.93

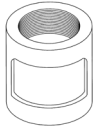

**EXTRA HEAVY
COUPLINGS
CLASS 300**

SIZE (INCHES)	B	G	INNER QTY	MASTER CARTON QTY	PART # BLACK	WEIGHT PER 100	PRICE (US\$) BLACK	PART # GALV.	WEIGHT PER 100	PRICE (US\$) GALV.
1/4			100	200	AXHS08001	17	92.33	AXHS07001	16	113.59
3/8			60	120	AXHS08002	26	92.33	AXHS07002	26	163.39
1/2			40	80	AXHS08003	42	103.01	AXHS07003	43	167.65
3/4			25	50	AXHS08004	65	118.46	AXHS07004	67	189.35
1			1	35	AXHS08005	101	135.51	AXHS07005	102	250.37
1-1/4			10	20	AXHS08006	168	161.10	AXHS07006	169	326.46
1-1/2			1	17	AXHS08007	203	241.13	AXHS07007	208	460.78
2			5	10	AXHS08008	349	347.27	AXHS07008	358	558.05
2-1/2			3	6	AXHS08009	548	622.07	AXHS07009	542	1436.28
3			2	5	AXHS08010	758	896.21	AXHS07010	758	1709.93
4			1	3	AXHS08011	1036	1192.10	AXHS07011	1045	2621.82



**EXTRA HEAVY
REDUCING
COUPLINGS
CLASS 300**

SIZE (INCHES)	B	G	INNER QTY	MASTER CARTON QTY	PART # BLACK	WEIGHT PER 100	PRICE (US\$) BLACK	PART # GALV.	WEIGHT PER 100	PRICE (US\$) GALV.
3/8 x 1/4			120	240	AXHRS08465	21	121.97	AXHRS07465	22	176.66
1/2 x 1/4			55	110	AXHRS08467	31	146.83	AXHRS07467	32	236.91
1/2 x 3/8			50	100	AXHRS08468	34	146.83	AXHRS07468	35	236.91
3/4 x 3/8			35	70	AXHRS08471	46	203.80	AXHRS07471	46	369.78
3/4 x 1/2			35	70	AXHRS08472	50	150.17	AXHRS07472	51	287.57
1 x 1/2			15	45	AXHRS08476	71	182.91	AXHRS07476	73	350.32
1 x 3/4			15	45	AXHRS08477	79	179.36	AXHRS07477	81	343.37
1-1/4 x 1/2			24	48	AXHRS08481	111	364.11	AXHRS07481	115	551.60
1-1/4 x 3/4			15	30	AXHRS08482	119	244.97	AXHRS07482	121	429.20
1-1/4 x 1			1	25	AXHRS08483	126	236.08	AXHRS07483	129	390.10
1-1/2 x 1/2			24	48	AXHRS08487	144	378.38	AXHRS07487	114	683.78
1-1/2 x 3/4			20	40	AXHRS08488	154	335.88	AXHRS07488	163	531.86
1-1/2 x 1			10	20	AXHRS08489	162	323.51	AXHRS07489	168	531.86
1-1/2 x 1-1/4			10	20	AXHRS08490	181	367.83	AXHRS07490	183	586.66
2 x 1/2			12	24	AXHRS08494	238	546.05	AXHRS07494	246	1094.22
2 x 3/4			12	24	AXHRS08495	236	546.05	AXHRS07495	245	1094.22
2 x 1			12	24	AXHRS08496	243	468.95	AXHRS07496	251	852.74
2 x 1-1/4			1	13	AXHRS08497	267	552.46	AXHRS07497	272	1094.22
2 x 1-1/2			6	12	AXHRS08498	275	465.26	AXHRS07498	282	761.17
2-1/2 x 1-1/2			4	8	AXHRS08506	400	880.47	AXHRS07506	376	2032.58
2-1/2 x 2			4	8	AXHRS08507	438	880.47	AXHRS07507	440	2019.43
3 x 2			3	6	AXHRS08513	621	1290.21	AXHRS07513	635	3298.13
3 x 2-1/2			1	5	AXHRS08514	663	1339.63	AXHRS07514	729	3298.13
4 x 3			1	3	AXHRS08526	958	2740.17	AXHRS07526	900	5143.03

Δ sold in inner quantity only

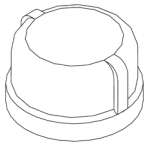

EXTRA HEAVY CAPS CLASS 300

SIZE (INCHES)	B	G	INNER QTY	MASTER CARTON QTY	PART # BLACK	WEIGHT PER 100	PRICE (US\$) BLACK	PART # GALV.	WEIGHT PER 100	PRICE (US\$) GALV.
1/4			120	240	AXHCA08127	2	95.10	AXHCA07127	2	116.67
3/8			110	220	AXHCA08128	14	94.54	AXHCA07128	14	115.77
1/2			60	120	AXHCA08129	22	93.87	AXHCA07129	23	169.92
3/4			40	80	AXHCA08130	34	118.46	AXHCA07130	35	203.14
1			20	40	AXHCA08131	54	155.34	AXHCA07131	55	278.00
1-1/4			15	30	AXHCA08132	88	172.16	AXHCA07132	90	329.83
1-1/2			12	24	AXHCA08133	111	251.52	AXHCA07133	115	462.43
2			5	15	AXHCA08134	186	349.34	AXHCA07134	191	639.83
2-1/2			3	9	AXHCA08135	313	654.99	AXHCA07135	326	1472.86
3			3	6	AXHCA08136	465	903.87	AXHCA07136	496	2010.96
4			2	4	AXHCA08137	747	1484.48	AXHCA07137	692	2641.60

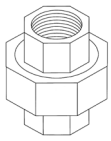

EXTRA HEAVY UNIONS BRASS TO IRON CLASS 300

SIZE (INCHES)	B	G	INNER QTY	MASTER CARTON QTY	PART # BLACK	WEIGHT PER 100	PRICE (US\$) BLACK	PART # GALV.	WEIGHT PER 100	PRICE (US\$) GALV.
1/8			200	400	AXHCU08182	23	222.90	AXHCU07182	29	268.39
1/4			65	130	AXHCU08183	32	209.02	AXHCU07183	33	268.39
3/8			50	100	AXHCU08184	46	211.46	AXHCU07184	46	273.70
1/2			25	50	AXHCU08185	61	171.09	AXHCU07185	61	259.57
3/4			15	30	AXHCU08186	85	189.43	AXHCU07186	89	281.49
1			12	24	AXHCU08187	143	247.33	AXHCU07187	143	373.29
1-1/4			5	15	AXHCU08188	202	403.49	AXHCU07188	215	520.59
1-1/2			5	10	AXHCU08189	252	422.47	AXHCU07189	250	626.70
2			4	8	AXHCU08190	413	523.20	AXHCU07190	421	752.22
2-1/2			1	5	AXHCU08191	665	1686.99	AXHCU07191	664	2098.40
3			1	3	AXHCU08192	1068	2182.48	AXHCU07192	1064	3548.99
4			1	1	AXHCU08193	1863	6926.88	AXHCU07193	1871	8901.07

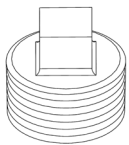

PLUGS - REGULAR CORED

SIZE (INCHES)	B	G	INNER QTY	MASTER CARTON QTY	PART # BLACK	WEIGHT PER 100	PRICE (US\$) BLACK	PART # GALV.	WEIGHT PER 100	PRICE (US\$) GALV.
1/8	Δ	Δ	300	3600	AP04168	1	13.46	AP03168	1	21.95
1/4			250	1000	AP04169	3	16.00	AP03169	3	26.05
3/8			50	600	AP04170	5	16.00	AP03170	5	26.05
1/2			175	350	AP04171	9	16.87	AP03171	10	32.64
3/4			55	220	AP04172	15	16.87	AP03172	15	32.64
1			55	110	AP04173	24	21.29	AP03173	25	35.76
1-1/4			20	80	AP04174	41	26.87	AP03174	41	55.07
1-1/2			1	55	AP04175	55	37.38	AP03175	56	74.33
2			1	35	AP04176	85	53.36	AP03176	86	94.38
2-1/2			10	20	AP04177	112	97.27	AP03177	116	184.11
3			7	14	AP04178	166	133.48	AP03178	170	261.17
4			1	7	AP04179	328	280.10	AP03179	340	542.09
6			1	2	AP04181	602	744.24	AP03181	602	1075.22

Δ sold in inner quantity only

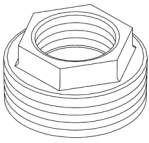

HEXAGON BUSHINGS

SIZE (INCHES)	B	G	INNER QTY	MASTER CARTON QTY	PART # BLACK	WEIGHT PER 100	PRICE (US\$) BLACK	PART # GALV.	WEIGHT PER 100	PRICE (US\$) GALV.
1/4 x 1/8	Δ	Δ	120	1440	ABU04547	3	27.95	ABU03547	3	40.26
3/8 x 1/8	Δ		75	900	ABU04548	6	27.95			
3/8 x 1/4			250	750	ABU04549	4	33.18	ABU03549	5	47.83
1/2 x 1/8	Δ	Δ	150	600	ABU04550	11	27.95	ABU03550	10	40.26
1/2 x 1/4			100	400	ABU04551	9	33.18	ABU03551	10	47.83
1/2 x 3/8			125	500	ABU04552	8	33.18	ABU03552	8	47.83
3/4 x 1/8	Δ		75	300	ABU04553	17	27.43	ABU03553	17	54.87
3/4 x 1/4			75	300	ABU04554	14	32.61	ABU03554	14	49.34
3/4 x 3/8			125	250	ABU04555	12	32.61	ABU03555	12	54.87
3/4 x 1/2	Δ	Δ	125	250	ABU04556	11	30.11	ABU03556	11	44.28
1 x 1/8			50	200	ABU04557	21	37.64	ABU03557	21	52.09
1 x 1/4			50	200	ABU04558	20	40.66	ABU03558	21	58.43
1 x 3/8			50	200	ABU04559	19	41.45	ABU03559	18	91.59
1 x 1/2	Δ	Δ	35	140	ABU04560	23	30.95	ABU03560	24	53.01
1 x 3/4	Δ	Δ	50	150	ABU04561	19	30.95	ABU03561	19	50.04
1-1/4 x 1/4			30	120	ABU04563	29	52.46	ABU03563	30	84.41
1-1/4 x 3/8			30	120	ABU04564	26	46.51	ABU03564	28	84.41
1-1/4 x 1/2	Δ	Δ	25	100	ABU04565	32	44.48	ABU03565	33	74.14
1-1/4 x 3/4	Δ	Δ	20	80	ABU04566	41	39.89	ABU03566	42	67.52
1-1/4 x 1	Δ	Δ	25	100	ABU04567	30	39.89	ABU03567	30	67.52
1-1/2 x 1/4			25	75	ABU04569	39	61.34	ABU03569	41	107.25
1-1/2 x 3/8			25	75	ABU04570	38	61.34	ABU03570	39	107.25
1-1/2 x 1/2			25	75	ABU04571	43	50.66	ABU03571	44	98.00
1-1/2 x 3/4			25	75	ABU04572	42	50.66	ABU03572	43	98.00
1-1/2 x 1			20	60	ABU04573	48	44.42	ABU03573	50	88.28
1-1/2 x 1-1/4	Δ	Δ	25	75	ABU04574	32	50.79	ABU03574	34	81.53
2 x 1/2			20	60	ABU04578	62	76.48	ABU03578	63	122.36
2 x 3/4			20	60	ABU04579	69	64.60	ABU03579	71	113.92
2 x 1			15	45	ABU04580	68	60.58	ABU03580	70	107.75
2 x 1-1/4			10	40	ABU04581	85	60.58	ABU03581	86	107.75
2 x 1-1/2			15	45	ABU04582	70	67.52	ABU03582	72	94.45
2-1/2 x 3/4			15	30	ABU04587	95	110.15	ABU03587	96	177.18
2-1/2 x 1			15	30	ABU04588	101	110.15	ABU03588	101	177.18
2-1/2 x 1-1/4			15	30	ABU04589	110	110.15	ABU03589	111	177.18
2-1/2 x 1-1/2			10	20	ABU04590	137	102.58	ABU03590	140	173.78
2-1/2 x 2			1	25	ABU04591	98	101.72	ABU03591	101	154.10
3 x 1			12	24	ABU04594	144	152.35	ABU03594	147	233.95
3 x 1-1/4			12	24	ABU04595	175	152.35	ABU03595	175	233.95
3 x 1-1/2			12	24	ABU04596	167	150.42	ABU03596	170	229.27
3 x 2			6	12	ABU04597	203	139.52	ABU03597	207	207.95
3 x 2-1/2			6	12	ABU04598	184	141.72	ABU03598	187	219.92
3-1/2 x 3			8	16	ABU04602	187	266.41	ABU03602	193	407.13
4 x 1-1/2			5	10	ABU04607	240	292.28	ABU03607	248	490.28
4 x 2			5	10	ABU04608	300	278.39	ABU03608	303	490.28
4 x 2-1/2			5	10	ABU04609	339	276.57	ABU03609	341	490.26
4 x 3			3	9	ABU04610	370	276.57	ABU03610	370	457.83

Δ sold in inner quantity only

Distributed by:

TERMS AND CONDITIONS OF SALE:

1. **PRICES:** This price sheet supersedes all previous issues. Prices in price sheets are subject to change without notice. Prices apply only to standard sizes as listed in catalog.
2. **APPROVAL & ACCEPTANCE OF ORDERS:** All orders are accepted on the basis of prices in effect at the time of shipment.
3. **TAXES:** Any Manufacturer or Sales Tax payable on the transaction under any effective statute will be added to the prices and terms quoted, unless a valid exemption certificate is on file.
4. **CREDIT TERMS:** Two percent cash discount tenth prox., - Net 30 days. Unless otherwise stated.
5. **DELIVERY & SHIPMENT OF GOODS:** All goods are shipped at buyer's risk. Shipments should be carefully examined upon delivery and before the carrier's delivery receipt is signed. If any loss or damage is evident, the buyer should make an appropriate notation on the delivery receipt and insist that the carrier's driver initial such exception. The contents of all packages should be carefully examined for concealed damage as soon as possible after delivery, so that the carrier can be requested, within 48 hours after delivery, to arrange for prompt inspection of the damaged goods. Completion of all orders accepted and fulfillment of all agreements or contracts entered into are subject to any delay which might be occasioned by labor disputes, fires, accidents, embargoes, trade restrictions, governmental directives or other causes beyond our control. All promises of shipment will be as closely estimated as possible. We use our efforts in every case to ship within the time promised, but cannot guarantee to do so. All claims for shortage must be made on receipt of goods. We prove our count by weighing the package. Claims for shortage are subject to that test. Typographical, clerical, arithmetical errors or omissions in orders, invoices, quotations, price schedules, acknowledgments, or other documents are subject to correction.
6. **RETURN OF GOODS:** No goods will be taken back and credited without prior approval and issuance of a return goods authorization (RGA) number. All fittings returned with our permission must be goods sold by Ward Manufacturing, LLC, and in clean saleable condition. Credit will only be allowed on the basis of prices agreed upon. If product returned is a result of a customer ordering error or overstocking situation, the credit will be less 20 percent to cover handling costs, less any costs of returning to a saleable condition, and less transportation charges on original and return shipments. Orders for special goods are not subject to cancellation for any reason after work has been started on them, except upon agreement to make payment for all work which has been performed.
7. **WARRANTY:** Seller warrants the material to be free of defects in material and workmanship, under normal use, proper maintenance and proper operation, for a period of one year from date of delivery to a common carrier for shipment to buyer or his designated agent. The obligation of the seller is limited to (1) repair of the material, or (2) replacement of any component or components proven defective in material or workmanship, or (3) refund of the purchase price. Seller shall have no liability for the cost of removal or reinstallation with respect to any replaced or repaired product. The election of said remedies shall be determined by seller in its sole discretion and shall be considered final disposition. All implied warranties, including the implied warranties of merchantability and fitness for a particular purpose, are hereby disclaimed and excluded. This warranty is in lieu of all other warranties, guarantees, agreements and similar obligations of seller; in no event shall seller be liable for consequential or incidental damages.
8. **FREIGHT TERMS:** Shipments of \$5,000 net (combined product or more) will be shipped prepaid in the continental US (except Alaska). We reserve the right to choose shipping point and carrier.
9. **CARTON & BOX QUANTITY ADJUSTMENT:** On orders received for less than master carton or box quantities, we reserve the right to adjust to the next carton or box quantity above the number of pieces shown on the order. Items subject to adjustment are identified with stars on the price sheet.
10. **WEIGHTS:** The weights per piece or per 100 pieces given on the price sheet, catalogs, and quotations are not guaranteed, but are approximate and for your convenience.
11. **SPECIAL CONDITIONS:** Any additional cost incurred in packaging or in making any special tests or inspection requested by Buyer in addition to those commercially supplied by Ward Manufacturing, LLC, will be charged to Buyer. Such tests and inspections will be made at the factory before the date of shipment. Orders for fittings or parts will be subject to a net minimum invoice charge of \$50,000 net plus applicable handling and freight charges.
12. **US EXPORT COMPLIANCE:** The products sold by Ward Manufacturing, LLC may be subject to export control laws and regulations of the United States Government. Buyer may not make any disposition of such products, by way of sale, export, re-export, transshipment or otherwise, except as permitted under applicable U.S. law.